

SUPERMASTER ACTUATOR

ACTUATORS CHAIN ACTUATORS

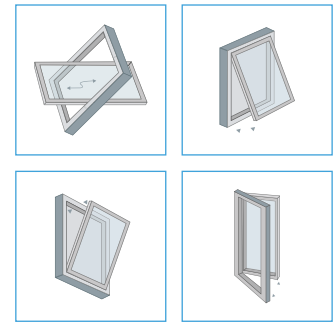

■ Applications



■ Colours

White (RAL 9010)
Dark Brown Anodised
Silver Anodised



■ SUPERMASTER ACTUATOR

- Heavy duty actuator with powerful thrust and strong, double link stainless steel chain.
- Ideal for heavy windows or windows requiring large opening.
- Choice of 450mm, 600mm, 800mm or 1000mm travel.
- High speed and virtually noiseless operation.
- All types of fixing brackets supplied seperately.



230V

24V

TECHNICAL DATA:

CODE	SMD	SMA
VOLTAGE	24VDC	230VAC
STROKE	450 / 600 / *800 / *1000mm	450 / 600 / *800 / *1000mm
THRUST FORCE	400N (*300N)	400N (*300N)
ABSORBED CURRENT	2A	0.8A
SPEED	20mm/s	23mm/s
PROTECTION CLASS	IP20	IP20
WIRING	1.5m (3 CORE)	1.5m (4 CORE)
COLOURS	WHITE / DARK BROWN / SILVER	WHITE / DARK BROWN / SILVER
LIMIT STOP	MICRO SWITCH	MICRO SWITCH
SAFETY STOP	THERMIC	THERMIC
MAX WINDOW WIDTH	< 1.5m	< 1.5m

DIMENSIONS:

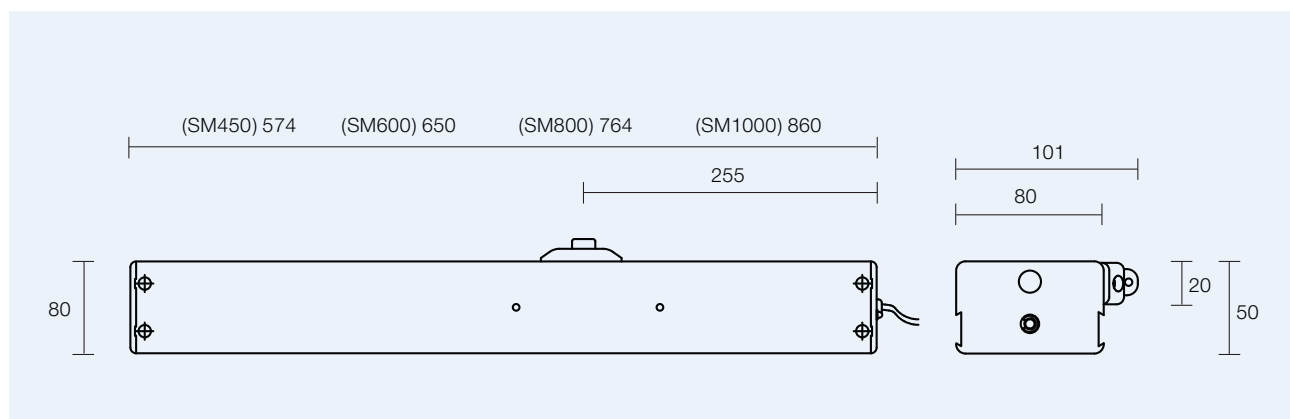

BRACKET TYPES:

SM40460
Slide Bracket

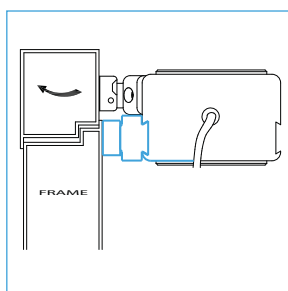

SM40560
Pivot Bracket

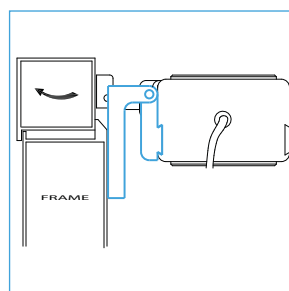

SM40560
Pivot Bracket

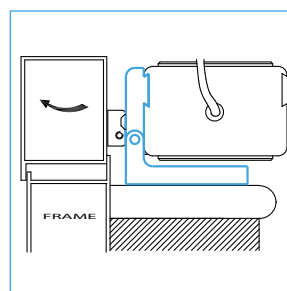

SM40472
Bottom Hung Bracket

