

POWERMASTER ACTUATOR

ACTUATORS CHAIN ACTUATORS



■ Applications



■ Colours

Silver Anodised



■ POWERMASTER ACTUATOR

- 200N thrust 230Vac or 24Vdc chain actuator.
- Strong double link chain.
- Choice of 380mm, 660mm or 860mm (24Vdc only) strokes.
- Supplied complete with PMSB standard pivot brackets.
- PMBHB bottom hung, PMSPB small pivot and PMLPB large pivot brackets also available.
- Supplied complete with 1.5m cable.



230V

24V

TECHNICAL DATA:

CODE	PM24	PM230
VOLTAGE	24VDC	230VAC
STROKE	380 / 660 / 860mm	380 / 660mm
THRUST FORCE	200N	200N
ABSORBED CURRENT	1A	0.6A
SPEED	18mm/s	18mm/s
PROTECTION CLASS	IP32	IP32
WIRING	1.5m (2 CORE)	1.5m (4 CORE)
COLOURS	SILVER ANODISED	SILVER ANODISED
LIMIT STOP	MICRO SWITCH	MICRO SWITCH
SAFETY STOP	ELECTRONIC	ELECTRONIC
MAX WINDOW WIDTH	<1.5m	<1.5m

DIMENSIONS:

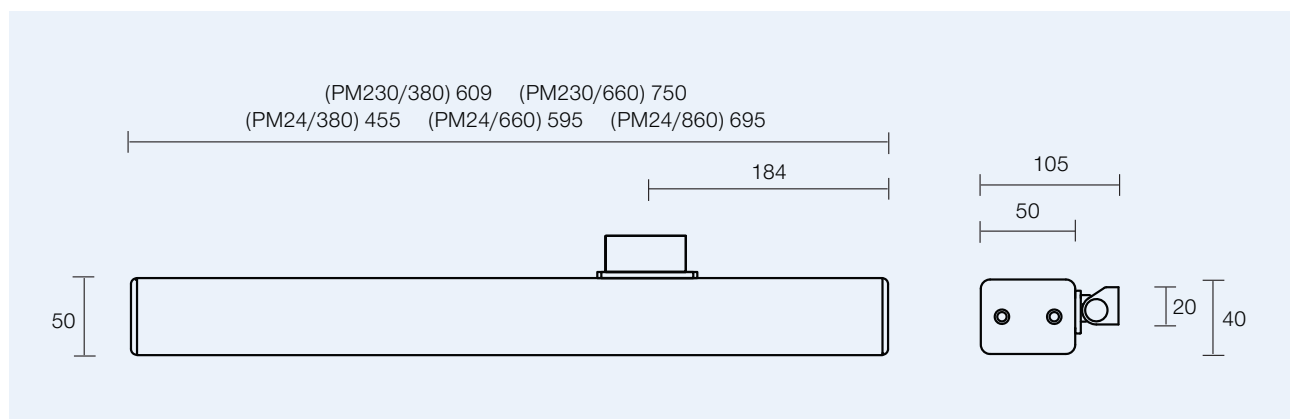

BRACKET TYPES:

PMSB*
Standard Bracket

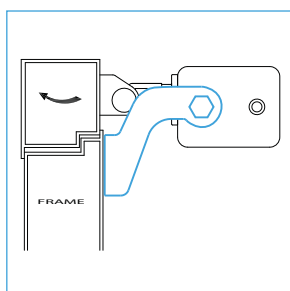

PMSPB
Small Pivot Bracket

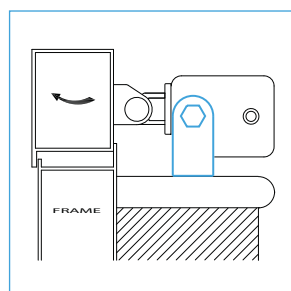

PMLPB
Large Pivot Bracket

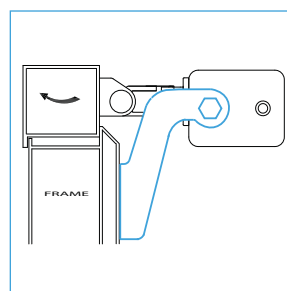

PMBHB
Bottom Hung Bracket

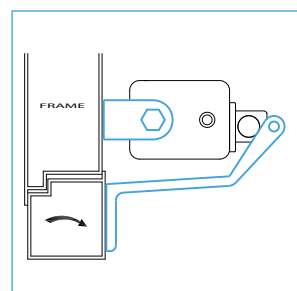

* Supplied complete with actuator